

- ❖ 前推式弹性筒夹夹头，适合CNC车床，专业机，或其它旋削机械。
- ❖ 高精度，高转速及高刚性结构。
- ❖ 安装连结方式与中空夹头一样，且可与之相容互换，不必更改拉
- ❖ 搭配弹性筒夹须符合DIN 6343规范。

- ❖ It's a PUSH type collet are used mainly on turning on, CNC, special purpose machines and other, etc.
- ❖ High clamping accuracy, high speed and construction of high rigidity.
- ❖ The installation is the same as "Thru-hole power chuck" and they are replaceable with each other. No need to change the "Draw tube".
- ❖ The collet used must accord with DIN 6343.

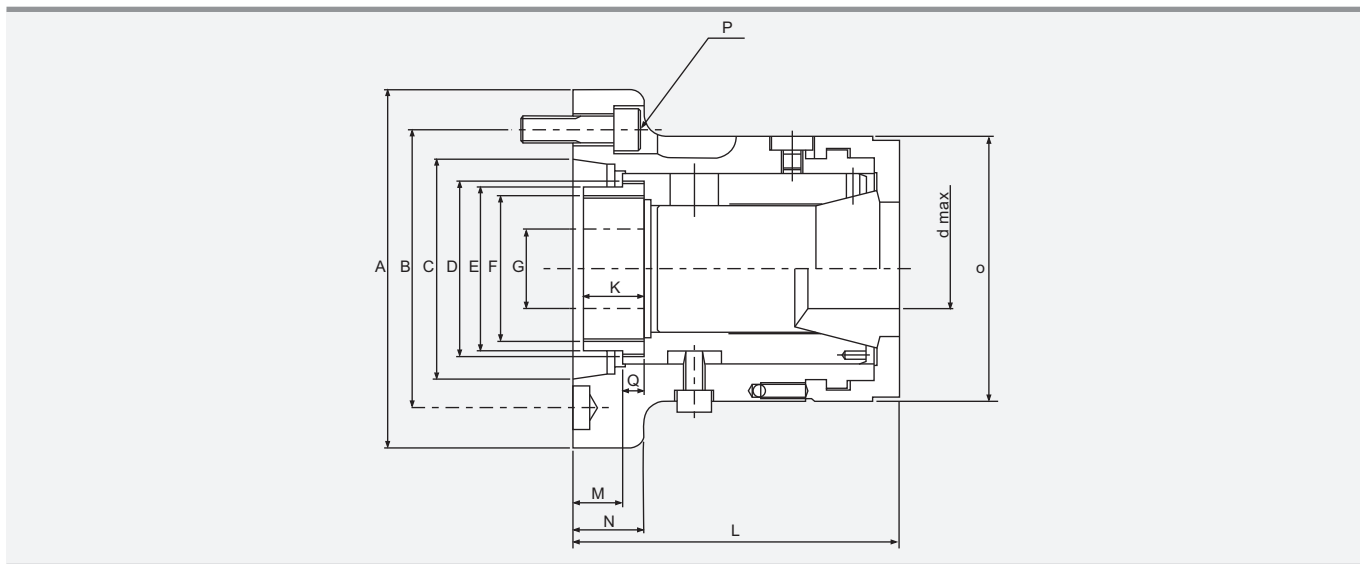

規格 Spec 寸法 Size	BC30-A4	BC36-A5	BC42-A5	BC42-A6	BC52-A5	BC52-A6	BC60-A6	BC60-A8	BC80-A8
Max.Speed	7000	6000	6000	6000	6000	6000	5000	5000	4000
Steel Cilet	163E	171E	173E	173E	177E	177E	185E	185E	193E
A	112	135	135	170	135	170	170	220	220
B	82.6	104.8	104.8	133.4	104.8	133.4	133.4	171.4	171.4
C	63.5	82.56	82.56	106.36	82.56	106.36	106.36	139.7	139.7
D	M50 × P1.5	M66 × P1.5	M66 × P1.5	M66 × P1.5	M70 × P1.5	M90 × P1.5	M90 × P1.5	M90 × P1.5	M114 × P2.0
E	45	62	62	66	62	66	66	90	108
F	M40 × P1.5	M55 × P2.0	M55 × P2.0	M60 × P2.0	M55 × P2.0	M60 × P2.0	M60 × P2.0	M85 × P2.0	M100 × P2.0
G	20	30	30	30	30	30	30	30	30
K	23	23	23	23	23	31	31	31	31
M max	21.5	26	26	29	26	33	33	33	34
M min	16.5	21	21	24	21	28	28	28	29
N	30	27	27	32	27	27	27	37	35
d	30	36	42	42	52	52	60	60	80
o	87	103	103	103	113	132	132	132	155
L	110	129	129	133	129	155	155	155	175
P	3-M10 × 30	4-M10 × 30	4-M10 × 30	4-M12 × 30	4-M10 × 30	4-M12 × 30	4-M12 × 30	4-M16 × 35	6-M16 × 35
Q	8	8	8	8	8	8	8	8	11